

Street charging station - from 7 kW up to 22 kW.

The AGICITY AP model has been designed for street charging, whether in public or private domains. It can also be installed outdoor. The AGICITY AP PRIMO version has been especially designed for car sharing / car clubbing applications, equipped with a touch screen and key boxes.

## DESCRIPTION

### Configuration

Power supply: from 2x 7 kW to 2x 22 kW

Compatible plug sockets : Type 2, Type 2S

Electrical protections: embedded or customized.

Easily convertible between single and three phase

Two different configurations (for each power supply) are available:

- Master : embed the pool manager and/or cellular connectivity (2G/4G)
- Slave : can be managed by a master charging station via an Ethernet connexion

### Identification (IHM)

- RFID reader: ISO 14443A, ISO 14443B, MiFare, Calypso

### Communication & commissioning

- Local communication: Ethernet (IEEE 802.3)
- Commissioning through a web interface
- Remote communication: 2G/4G ou Ethernet (IEEE 802.3)
- Interoperability OCPP1.6
- Integrated pool manager :
  - communication gateway for slave
  - local energy manager

## ASSOCIATED SERVICES

### Smart charging

Power limitation for one or more plug sockets on the same pool, dynamic energy balancing using the pool manager.

The limitation can be :

- **Static:** the power supply limit is defined and static. It can be locally configured at the pool level and then modified through commissioning software.
- **Dynamic:** power supply changes according to charging requests and energy availability. The load balancing can operate locally on a charging station or a cluster. This function can be extended via a communicating metering device (optional) in order to meter both power consumption and power feeding from external production on the same delivery point.
- **Dynamic with local constraint:** power supply respects optimization strategies, taking into consideration external parameters, such as power pricing, through OCPP commands and commissioning software.

## Maintenance and supervision

- Remote management / diagnosis
- Preventative and on-going maintenance
- Real-time reporting and alerts



## STANDARDS

**International** EN 61851-1;  
EN 61851-22; EN 62196-2

**National** NF C 15-100;  
NF C 15-722

## Charge access

- Plug & charge
- Local user authentication through RFID
- Remote user authentication through RFID/OCPP
- Compatible with most the EMSP services

## CHARACTERISTICS

### Construction characteristics

Number of charging points	2 simultaneous
Material	Aluminium
Plug socket	Type 2 lockable + EF
Colour	Grey RAL 7043

### Dimensional characteristics

Approximate net weight	67.0 kg
------------------------	---------

### Usage characteristics

IP Rating	IP54
Installation type	Indoor/Outdoor
Operating temperature, range	-25 .. 50 °C

## RECOMMENDED ELECTRICAL PROTECTIONS FOR U.K. MARKET

Charge point protections	2 x RCCB - 30 mA, type A used in association with 6mA DC detection
	2x MCB - 40A, C curve, 3P+N
Internal protection	1x MCB - 6A , C Curve

## AGICITY AP LAYOUT AND OPTIONS

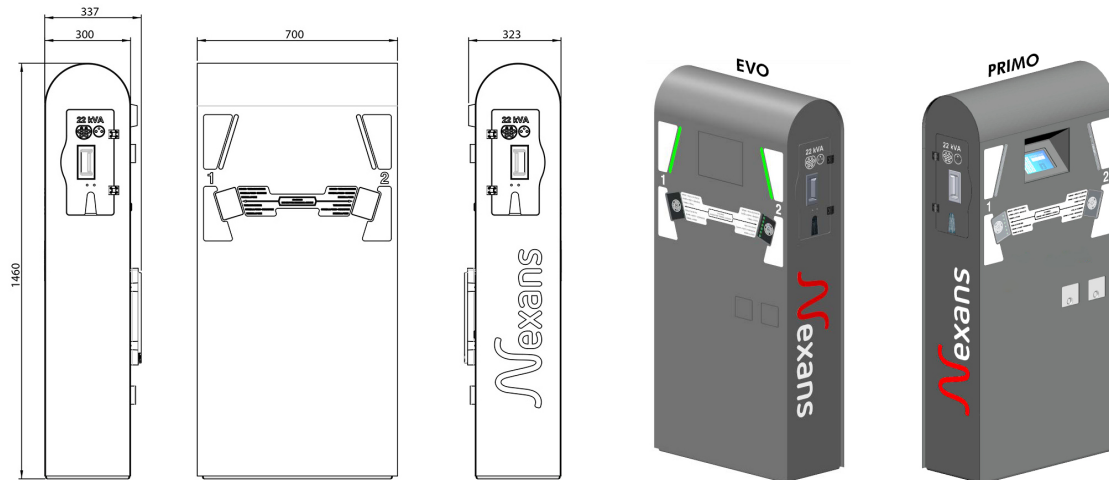

### OPTIONS

- IK10 Key boxes
- IK09 touch screen
- Charge cable holding kit
- Customisation (colour / stickers)
- Anti-graffiti coating